

Courses & Dist. up
Clarion River from Rock

N 18 1/2 E 38	S 84 1/2 E 9
N 2 E 80	S 81 E 7
N 13 E 29	S 72 E 16
N 20 1/2 E 24 1/2	S 67 E 48
N 30 1/2 E 18	S 84 E 12
N 37 E 11 1/2	S 44 E 66
N 42 E 8	S 71 E 20
N 60 1/2 E 10 1/2	S 85 E 24
N 88 1/2 E 8	

ALEXANDER BECK
231 A. 48 P.

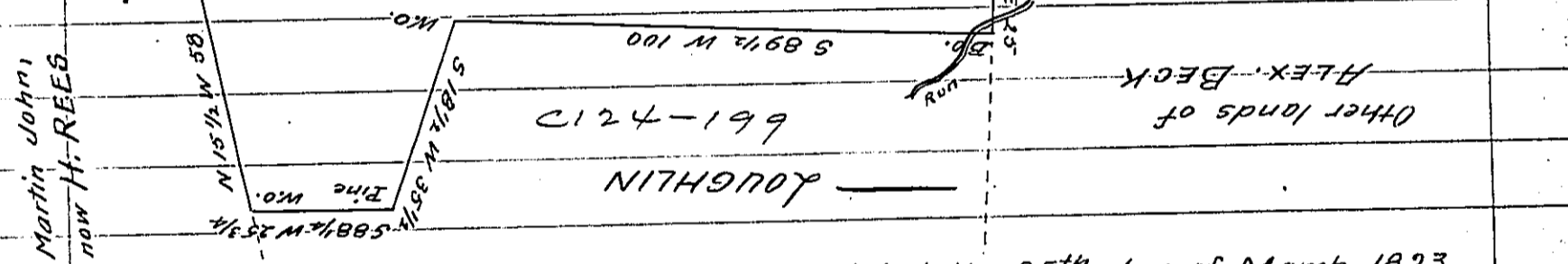

In pursuance of a warrant dated the 25th day of March 1823 granted to Alexander Beck, Surveyed March 24, 1848, to the said Alex. Beck the above described tract of land (improved and settled in 1823) situate in Piney Township Clarion Co. (formerly a part of Toby Tp. Armstrong Co Pa.) containing two hebliterah and thirty one acres and forty eight perches and allowance of six pr ct

J. K. Maxwell D.S.

To John Laporte Esq
Surveyor General.

IN TESTIMONY that the above is a copy of the original remaining on file in the Department of Internal Affairs of Pennsylvania, made conformably to an Act of Assembly approved the 16th day of February, 1833, I have hereunto set my Hand and caused the Seal of said Department to be affixed at Harrisburg, this twenty-first day of March 1904

James P. Brown
Secretary of Internal Affairs.